

**LAZOR SUPER AND LAZOR REGULAR  
BATTERY PACKS**

LA50261001

LA50262001

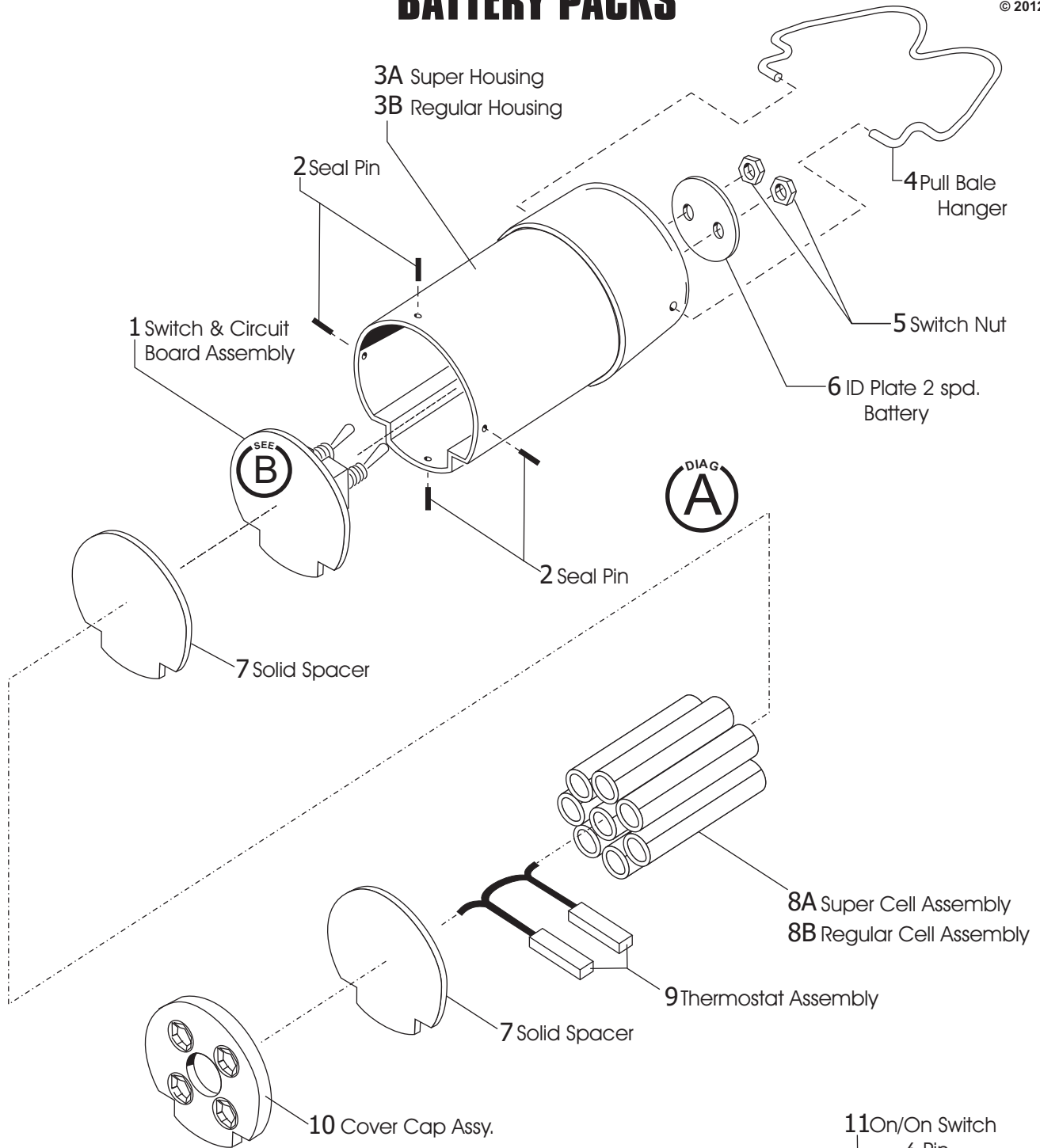

**COVER CAP ASSEMBLY DETAIL**

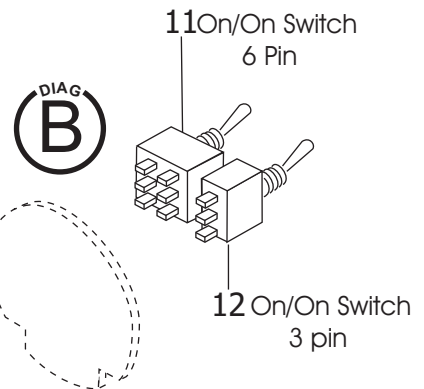
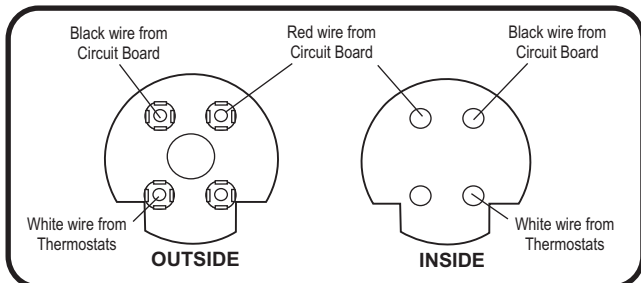



**LAZOR SUPER** A  
N  
D **LAZOR REGULAR**  
**BATTERY PACKS**

LA50261001

LA50262001

JANUARY 1, 2012  
 PO BOX 21259  
 Oxnard, CA 93034-1259  
 800-451-1355 805-240-1300  
 laubeco.com  
 © 2012

DIA.	ITEM	PART#	REQ'D	DESCRIPTION
A	1	SE5310000000	1	Switch & CB Assembly Lazor Battery (Nicad)
	2	SE5200040000	4	Seal Pin (minimum order 12)
	3A	SE5300020001	1	Battery Housing-Super 2 Speed
	3B	SE5300030001	1	Battery Housing-Regular 2 Speed
	4	SE5200020000	1	Bale Hanger (Lazor)
	5	SE5200030000	2	Switch Nut
	6	UA511704	1	ID Chip 2 Speed Battery
	7	SE5210060000	1	Solid Spacer (Lazor Battery / Mini Lazor)
	8A	SE5321000000	1	Cell Assembly - Super 2 Speed (Ni-Cad)
	8B	SE5332000000	1	Cell Assembly - Regular 2 Speed (Ni-Cad)
B	9	SE5300050000	1	Thermostat Assembly
	10	SE5320000001	1	Cover Cap Assembly-Thermal
	11	SE5210010000	1	Toggle Switch On/On 3 pin (On - On)
	12	SE5310030000	1	Toggle Switch On/On 6 pin (On - On)